











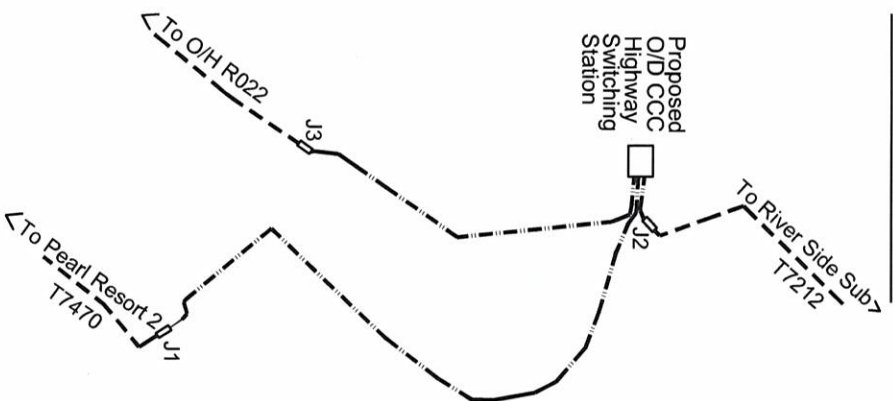

LEGEND

- | | |
|---|--|
|  | EXISTING GROUND MOUNTED TXR |
|  | PROPOSED O/D CCCC |
|  | EXISTING SWITCHING STATION TO BE REMOVED |
|  | PROPOSED U/G CABLE |
|  | EXISTING U/G CABLE
TO BE REMOVED |
|  | EXISTING UNDERGROUND CABLE |
|  | PROPOSED STRAIGHT THRU JOINT |

FINAL HV CIRCUIT



HV LEGEND

- | | |
|---|-------------------------------|
|  | OID SAFELINK SWITCH "CCCC" |
|  | EXISTING HV UNDERGROUND CABLE |
|  | PROPOSED HV UNDERGROUND CABLE |
|  | ROUTE LENGTH : HV = 205m |
|  | PROPOSED STRAIGHT THRU JOINT |

NOTES

1. Install 1 x CCCC O/D Safelink switchgear (to replace Highway Switching Station) as proposed.
2. Lay 240mm² 3C XLPE cable from proposed O/D Safelink Switchgear to existing Highway Switching Station site & make straight thru joint with existing Pearl Resort 2 as proposed.
RL = 150m
3. Lay 240mm² 3C XLPE cable from proposed O/D Safelink Switchgear to proposed joint at Old Queens Rd & make transition joint with existing OH cable towards R022 as proposed. RL = 50m
4. Make transition joint with existing cable to River Side Sub as proposed. RL = 5m
5. Terminate existing cable from River Side 1 Sub, proposed cables from OH line(R022) & Pearl 2 Padmount to O/D Safelink Switchgear & commission.
6. Decommission existing Highway Switching Station.
7. Add labels to all outgoing switches on the new 1 x CCCC O/D safelink.

FOR CABLE TRENCHING DETAILS REFER TO SHEET 2

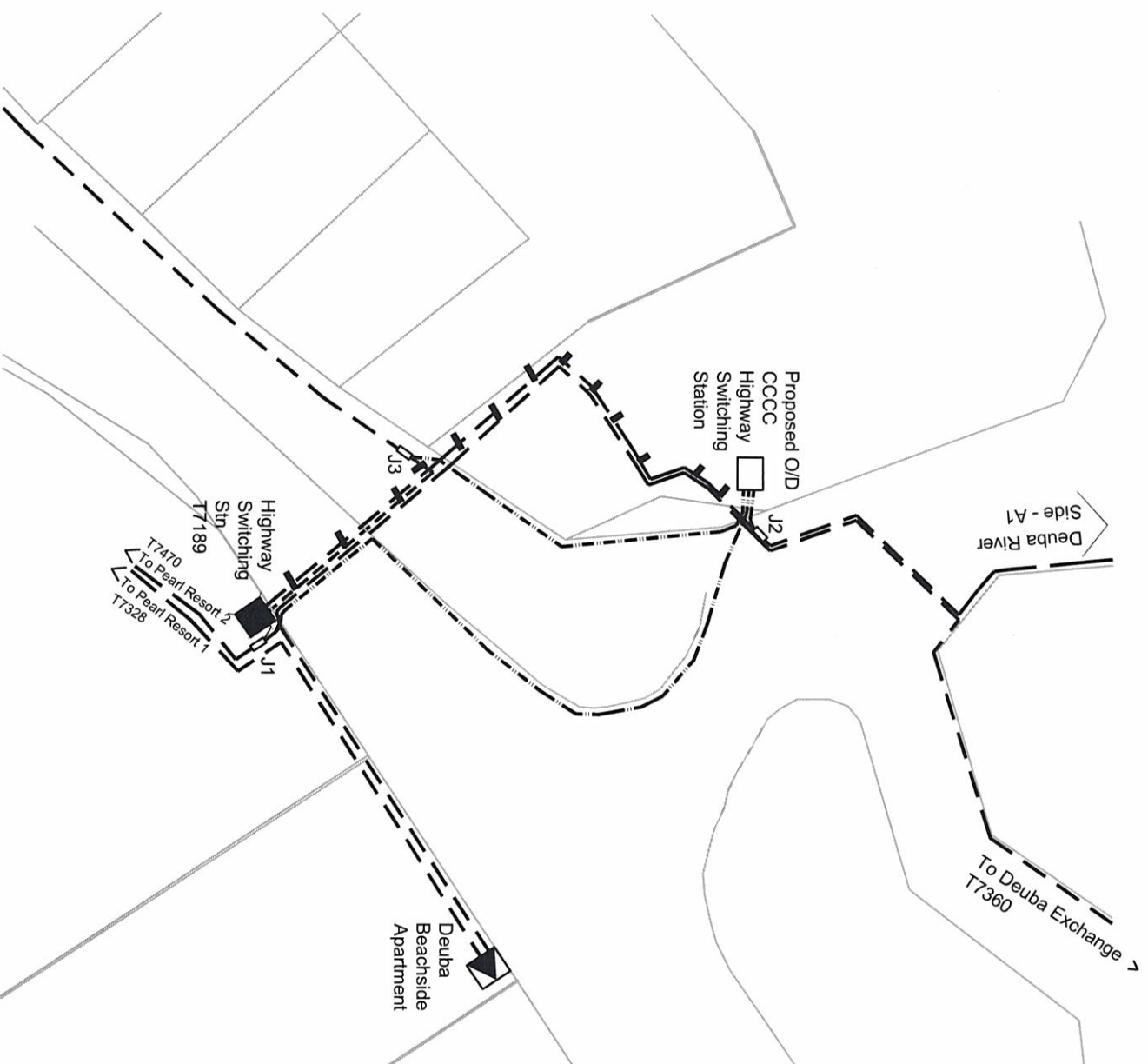

LOCALITY PLAN

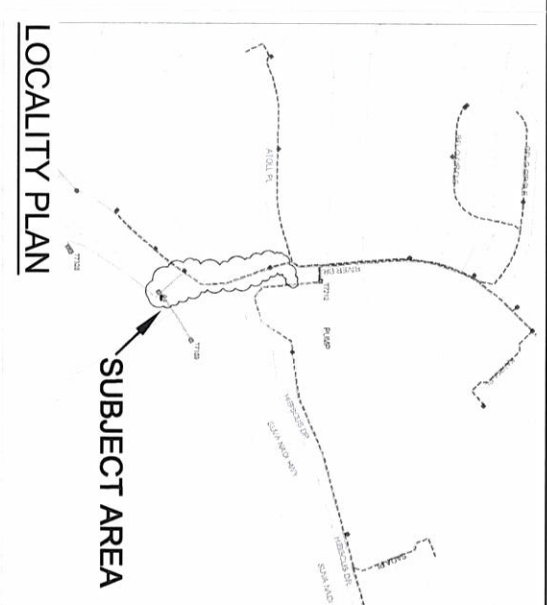
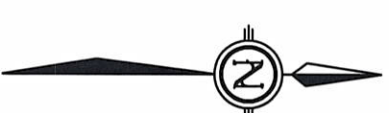

FINAL SINGLE LINE
REF. DRWG 04 N10 015

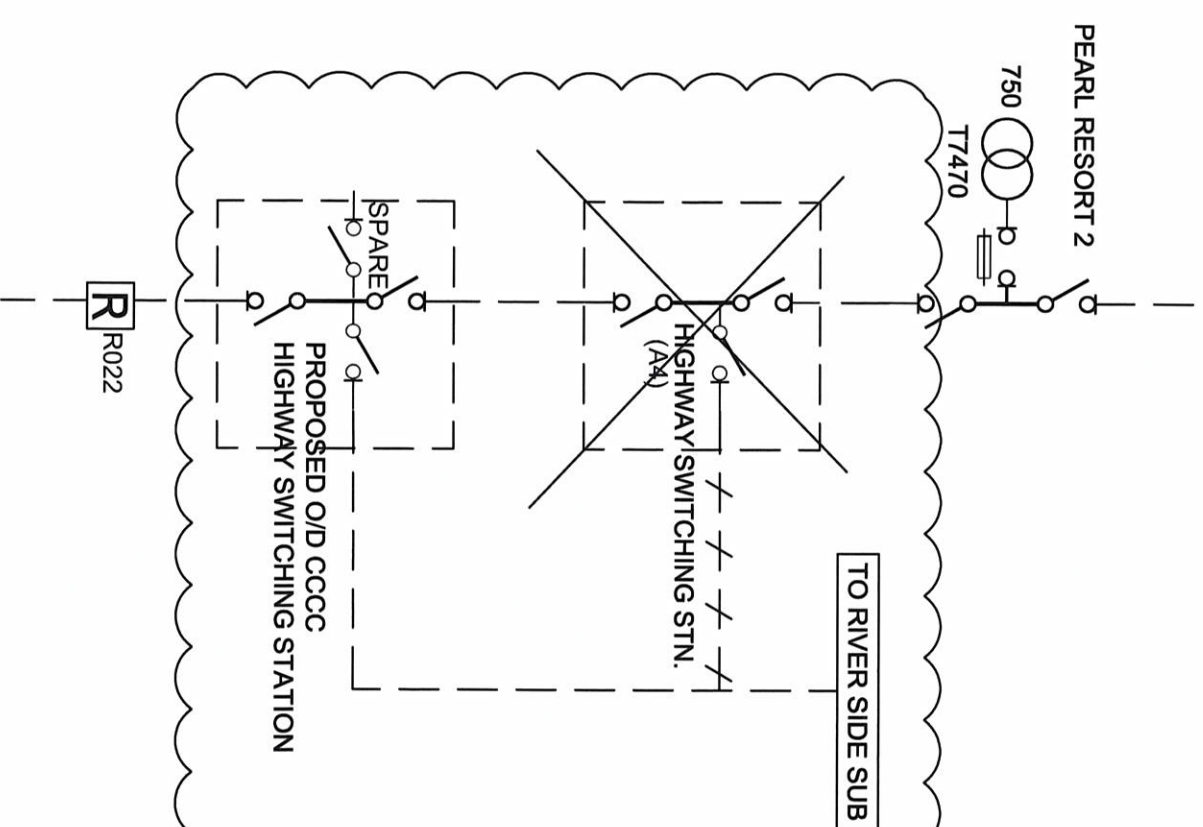
[illegible]