

LEGEND

- LV POLE
- EXISTING O/H CONDUCTOR
- - - PROPOSED O/H CONDUCTOR
- ⊥ GROUND STAY

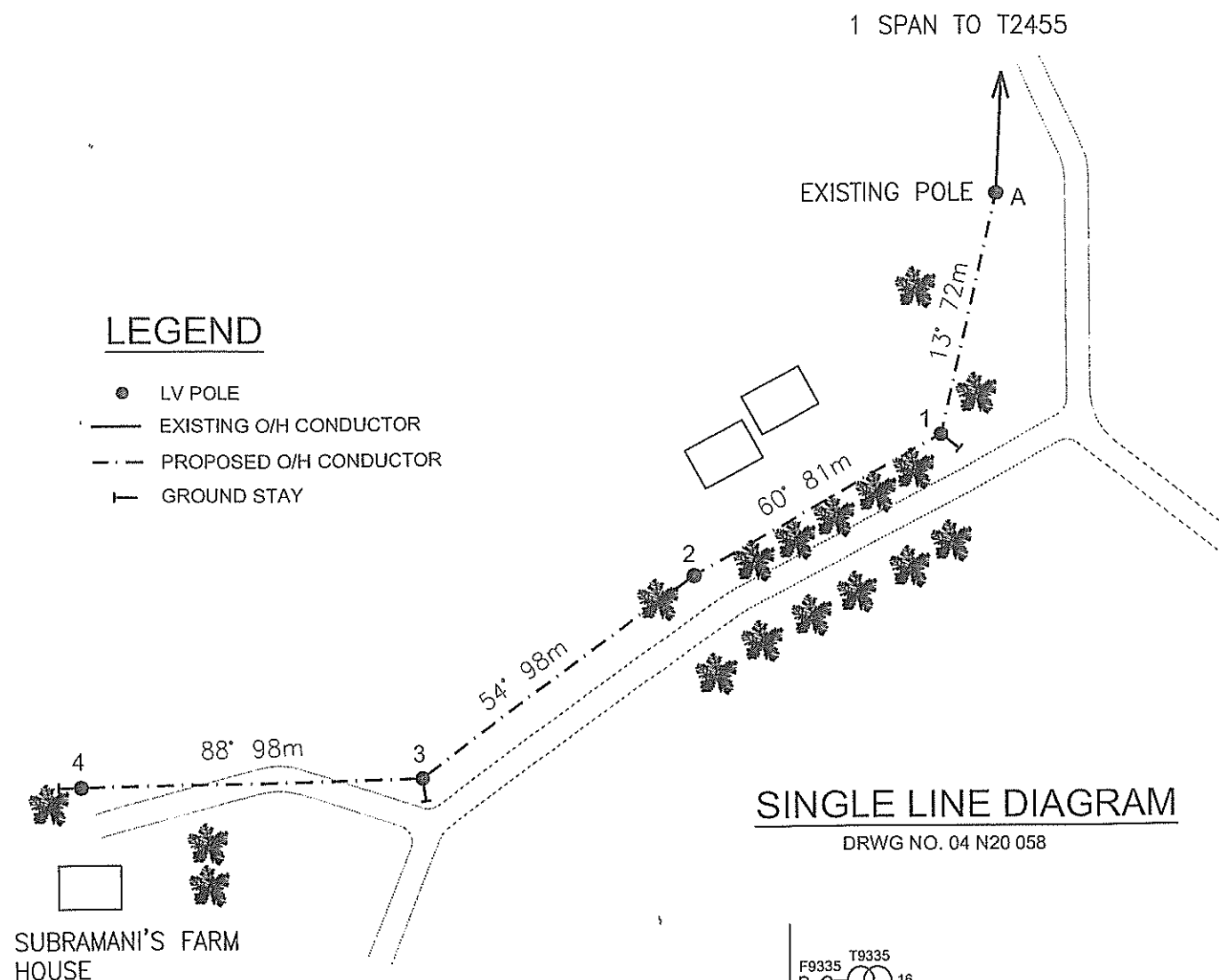

SINGLE LINE DIAGRAM

DRWG NO. 04 N20 058

SCOPE OF WORK

- ERECT 10.2m RC POLE @ LOCATIONS MARKED 1, 2, 3, & 4.
- STRING 1φ LV HELIUM CONDUCTOR FROM POLE A TO 4 VIA POLES 2 & 3.

LOCALITY PLAN

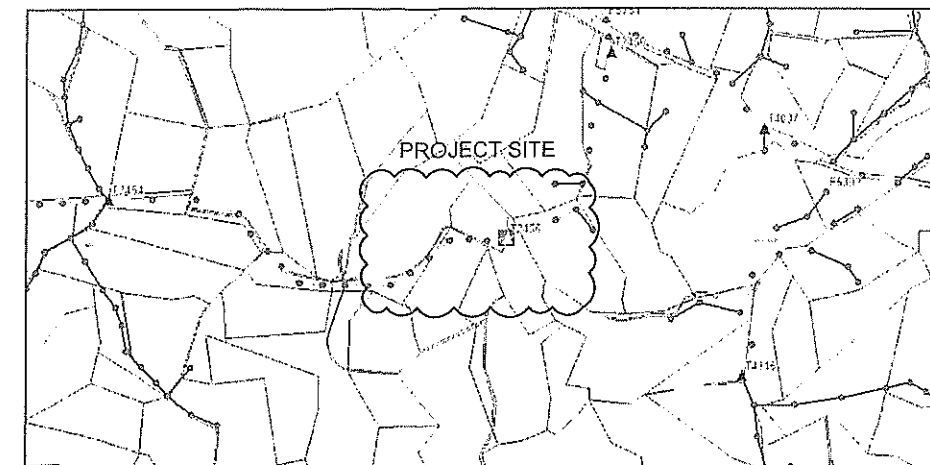

FINAL LV CIRCUIT

LEGEND

- LV POLE
- TERMINATION POINT
- ⊥ STRAIN POINT
- EXISTING O/H LINE
- - - STRING 2 x 7/3.75AAAC HELIUM
- TOTAL ROUTE LENGTH = 349m

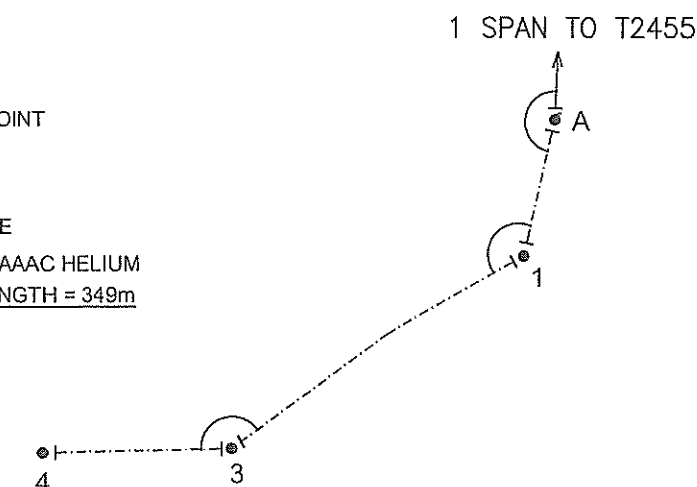

POLE SCHEDULE

POLE SCHEDULE									
POLE No.	POLE DESCRIPTION WOOD/CONC OR EXISTING	POLE Length and Strength m/kN	SPAN m	ANGLE OF LINE DEVIATION IN DEG.	POLE TOP DESCRIPTION OR TYPE No.				REMARKS
						GRND	SIDE-WALK	FLY	
A	EXIST.	EX	--	—	4A				STRING 1ø LV HELIUM ONLY
1	CONC.	10.2/6	72	47	4A	1			" " " " "
2	CONC.	10.2/6	81	6	1A				" " " " "
3	CONC.	10.2/6	98	34	2A	1			" " " " "
4	CONC.	10.2/6	98	—	3A	1			" " " " "

No.	REVISION	DATE	BY	CHK	PSD	APP
0	ORIGINAL ISSUE	27.9.17	JV			



DRAWN	SHANE	4.10.17
CHECKED	Kaushal	04.10.17
CHIEF DRAUGHTSMAN	Km	27/10/17
TEAM LEADER DESIGN & PLANNING	Ritesh.k	04/10/17
ENGINEER	J. Denea	04/10/17
HEAD OF DEPARTMENT		

FIJI ELECTRICITY AUTHORITY

ELECTRICITY SUPPLY TO SUBRAMANI'S FARM HOUSE
NADI DISTRICT
SOLOVI. FILE NO. (NA03/13)

DRAWING NUMBER

A3 04 N84 217

SCALE 1 : 2000